

Bleeder and venting valve

PLUS

Art. No. 103739

Type No. 223.10



Exemplary illustration

Brass drain valves are used at the lowest point of a pressure tank to condensate drain. Today they are generally used as a vent valve.

Discontinued product. No longer available. New product 145743 (223.10-1)

Technical data

Material	Brass
Sealant	NBR
Max. operating pressure	25 bar
Operating temperature	0 to 90 °C
Mounting position	any position
Design	angle type
Version	with hose fitting (hose I.D.12) and knurled screw
Thread	G 1/8
DN	5
Length	43.5 mm
i	8.5
D	20.0 mm

Commercial data

Customs tariff number	84219990
Country of origin	DE
eCl@ss 5.1.4	27292003
eCl@ss 9.0	27292003
UNSPSC_Code_v190501	40141603
UNSPSC_CodeDesc_v190501	Pneumatic valves

Material informations

REACH SVHC1 substance name	lead
CAS no. SVHC 1	7439-92-1
RoHS materials notice	RoHS compliant
REACH Info	contains SVHC substance

Dimensions

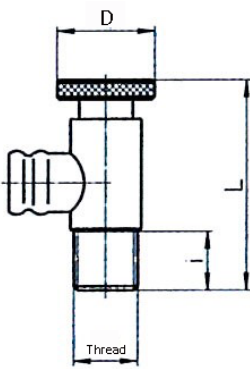

Thread	DN	Length mm	i	D mm
G 1/8	5	43.5	8.5	20.0