

5/3-way valve

pneumatic

PLUS

Art. No. 106508

Type No. 516.401

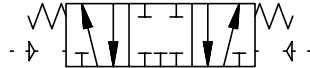

Exemplary illustration

Traditional way valves of series 70 in pneumatic version. These valves have a wide range of applications as bushing valves, direct mounting on the cylinder with special adapters or as series valves with multi-base plates and individual interlinking plates (supply strips).

Technical data

| | |
|-------------------------|--|
| Operating pressure | Vacuum to 10 bar |
| Temperature range | -10 to 60 °C |
| Pilot pressure | 2.5 - 10 bar |
| Medium | Filtered compressed air with or without lubrication. If lubricated, then continuous. |
| Sealant | NBR |
| Flow rate measurement 1 | Flow rate at 6 bar and Δp 0.5 bar |
| Flow rate 1 | 400 NI/min |
| Flow rate measurement 2 | Flow rate at 6 bar and Δp 1.0 bar |
| Flow rate 2 | 550 NI/min |
| Connection | G 1/8 |
| DN | 5 |
| Function | 5/3 |
| Operation | Mid-position closed |
| Symbol | 29 |
| Series | Valves series 70 |

Commercial data

| | |
|-------------------------|------------------|
| Customs tariff number | 84818079 |
| Country of origin | IT |
| eCl@ss 5.1.4 | 27291501 |
| eCl@ss 9.0 | 27291390 |
| UNSPSC_Code_v190501 | 40141603 |
| UNSPSC_CodeDesc_v190501 | Pneumatic valves |

VALVES SERIES 70

The Series 70 forms part of Metal Work's full range of traditional valves.
They are available in sizes 1/8", 1/4", 3/8" and 1/2", versions 3/2, 5/2, 5/3 and double 3/2, with mechanical, manual, pneumatic and electric drives.
They can be installed in line, onto a wall, on the cylinder (using a special bracket) or in series (on a multiple or modular base) to suit all possible applications.

A range of valves (Series 70 LT) designed using components for specific low-temperature applications is now available for the most commonly used types and sizes.

These highly reliable valves comply with the main applicable standards, including Atex, ISO 13489 and SIL, as stated in the documents and certificates available online.



| TECHNICAL DATA | | 1/8" | 1/4" | 3/8" | 1/2" |
|--|--------------------|--|--------|--------|--------|
| Thread on the valve ports | | 1/8" | 1/4" | 3/8" | 1/2" |
| Operating pressure series 70 versions | bar | 2.5 to 10 | | | |
| monostable and bistable differential | | 1 to 10 | | | |
| bistable | | vacuum to 10 | | | |
| asserved | | | | | |
| Operating pressure series 70 LT (low temperature) versions | bar | vacuum to 10 | | | |
| hand operated | | - | | | |
| pneumatic and solenoid/pneumatic | t = -40°C to -10°C | 5 to 10 | | | |
| | t = -10°C to +60°C | 3 to 10 | | | |
| Minimum pilot pressure | bar | 2.5 | | | |
| Operating temperature range | °C | -10 to +60 | | | |
| series 70 versions | | -40 to +60 | | | |
| series 70 LT (low temperature) versions | | | | | |
| Nominal diameter | mm | 5 | 7.5 | 13.3 | 15 |
| Conductance C | Nl/min · bar | 121.43 | 264.26 | 505.52 | 971.43 |
| Critical ratio b | bar/bar | 0.32 | 0.27 | 0.32 | 0.43 |
| Flow rate at 6 bar ΔP 0.5 bar | Nl/min | 400 | 750 | 1560 | 3200 |
| Flow rate at 6 bar ΔP 1 bar | Nl/min | 550 | 1100 | 2150 | 4600 |
| Installation | | In any position (vertical assembly is not recommended for bistable valves subjected to vibration) | | | |
| Fluid | | Filtered air without lubrication; lubrication, if used, must be continuous. | | | |
| Recommended lubricant | | For series 70 LT (low-temperature) versions, it is recommended to use of perfortemente dried air. ISO and UNI FD 22 | | | |
| Maximum coil nut torque | Nm | For series 70 LT (low-temperature) it is not expected to be used with lubricated air. 1 | | | |
| Compatibility with oils | | See chapter Z1 | | | |

COMPONENTS SERIES 70

- ① VALVE BODY: Aluminium
- ② CONTROL/END CAP: plastic
- ③ SPOOL: chemically nickel-plated aluminium
- ④ DISTANCE PLATES: plastic
- ⑤ GASKETS: NBR
- ⑥ PISTONS: Hostaform®
- ⑦ PISTON GASKET: NBR
- ⑧ FILTER: plastic
- ⑨ SPRINGS: special steel
- ⑩ OPERATOR: Brass pipe - Stainless steel core



COMPONENTS SERIES 70 LT (LOW TEMPERATURE)

- ① ALVE BODY: aluminium
- ② CONTROL/END CAP: aluminium
- ③ SPOOL: chemically nickel-plated aluminium
- ④ DISTANCE PLATES: plastic
- ⑤ GASKETS: HNBR
- ⑥ PISTONS: aluminium
- ⑦ PISTON GASKET: HNBR
- ⑧ FILTER: plastic
- ⑨ SPRINGS: special steel
- ⑩ OPERATOR: brass pipe - Stainless steel core
(version specific for low-temperature applications)



VALVES

VALVES SERIES 70

FLOW CHARTS

VALVES SERIES 70 1/8"

Flow rates



VALVES SERIES 70 1/4"

Flow rates



VALVES SERIES 70 3/8"

Flow rates



VALVES SERIES 70 1/2"

Flow rates





VALVES SERIES 70, PNEUMATIC

| TECHNICAL DATA | | 1/8" | 1/4" | 3/8" | 1/2" |
|--|--------------|--------------|--------|--------|--------|
| Operating pressure | bar | Vacuum to 10 | | | |
| Minimum pilot pressure | | | | | |
| • monostable and bistable differential | bar | 2.5 | | | |
| • bistable | bar | 1 | | | |
| Operating temperature range | °C | -10 to +60 | | | |
| Nominal diameter | mm | 5 | 7.5 | 13.3 | 15 |
| Conductance C | NI/min · bar | 121.43 | 264.26 | 505.52 | 971.43 |
| Critical ratio b | bar/bar | 0.32 | 0.27 | 0.32 | 0.43 |
| Flow rate at 6 bar ΔP 0.5 bar | NI/min | 400 | 750 | 1560 | 3200 |
| Flow rate at 6 bar ΔP 1 bar | NI/min | 550 | 1100 | 2150 | 4600 |
| TRA / TRR monostable at 6 bar | ms | 6/15 | 7/15 | 5/28 | 16/80 |
| TRA / TRR bistable at 6 bar | ms | 7/7 | 7/7 | 13/13 | 25/25 |



VALVES

VALVES SERIES 70, PNEUMATIC

SYNOPTIC, SIZES AND VERSIONS

| PNV FAMILY | 2 DIMENSIONS | 3 FUNCTION | PN OPERATORS 14 | S RESETTING (12) | NC FURTHER DETAILS |
|----------------------|--------------------------------------|--------------------------------------|-----------------|---|--|
| PNV pneumatic valves | 2 1/8" 3 1/4" C 3/8" 4 1/2" | 3 3/2 5 5/2 6 5/3 ■ 8 2-3/2 | PN pneumatic | S mechanical springs B bistable D differential O stable for 5/3 ◆ A pneumatic/mechanical spring | OO no indication NC normally closed NO normally open CC closed centres OC open centres PC pressure centres ▲ NC-NO normally closed - normally open |

- Only available for size 1/8" and 1/4"
- ◆ On demand
- ▲ Only available for function 2-3/2

VALVES SERIES 70, PNEUMATIC, 1/8"

MONOSTABLE 3/2 NO, 1/8"

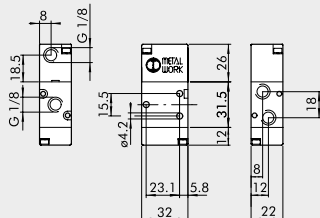

MONOSTABLE 3/2 NC, 1/8"

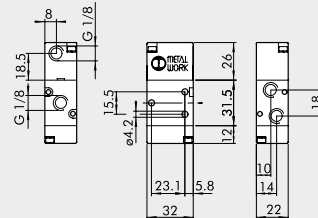

| Symbol | Code | Abbrev. | Weight [g] |
|--------|------------|---------------|------------|
| | 7010010400 | PNV 23 PNS NO | 82 |

| Symbol | Code | Abbrev. | Weight [g] |
|--------|------------|---------------|------------|
| | 7010010200 | PNV 23 PNS NC | 82 |

MONOSTABLE 5/2, 1/8"

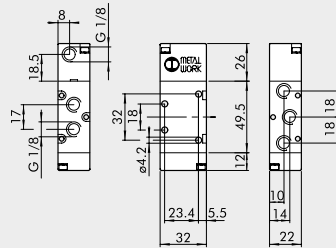

| Symbol | Code | Abbrev. | Weight [g] |
|--------|------------|---------------|------------|
| | 7010011100 | PNV 25 PNS OO | 108 |

BISTABLE 5/2, 1/8"

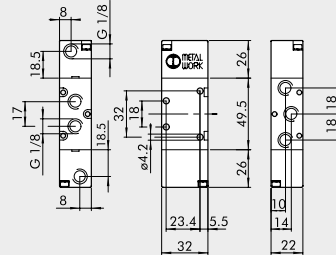

| Symbol | Code | Abbrev. | Weight [g] |
|--------|------------|---------------|------------|
| | 7010011200 | PNV 25 PNB OO | 122 |
| | 7010011300 | PNV 25 PND OO | 128 |

BISTABLE 3/2, 1/8"

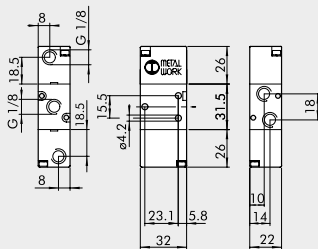

| Symbol | Code | Abbrev. | Weight [g] |
|--------|------------|---------------|------------|
| | 7010010100 | PNV 23 PNB OO | 96 |

DOUBLE 3/2 1/8"

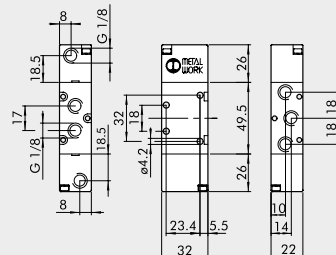

| Symbol | Code | Abbrev. | Weight [g] |
|--------|------------|------------------|------------|
| | 7010013100 | PNV 28 PNS NC | 136 |
| | 7010013200 | PNV 28 PNS NO | 136 |
| | 7010013300 | PNV 28 PNS NC-NO | 136 |

MONOSTABLE 5/3, 1/8"

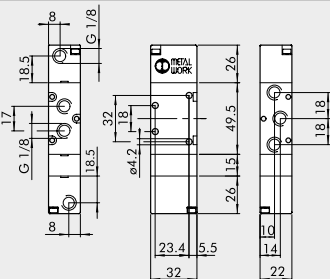

| Symbol | Code | Abbrev. | Weight [g] |
|--------|------------|---------------|------------|
| | 7010012100 | PNV 26 PNS CC | 150 |
| | 7010012200 | PNV 26 PNS OC | 150 |
| | 7010012300 | PNV 26 PNS PC | 150 |

NOTES



VALVES SERIES 70, PNEUMATIC, 1/4"

MONOSTABLE 3/2 NO, 1/4"



| Symbol | Code | Abbrev. | Weight [g] |
|--------|------------|---------------|------------|
| | 7020010400 | PNV 33 PNS NO | 124 |

MONOSTABLE 3/2 NC, 1/4"

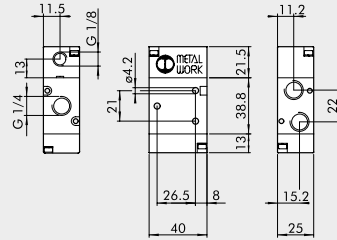

| Symbol | Code | Abbrev. | Weight [g] |
|--------|------------|---------------|------------|
| | 7020010200 | PNV 33 PNS NC | 122 |

MONOSTABLE 5/2, 1/4"

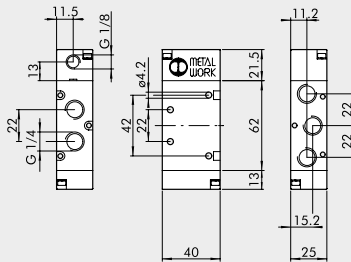

| Symbol | Code | Abbrev. | Weight [g] |
|--------|------------|---------------|------------|
| | 7020011100 | PNV 35 PNS OO | 174 |

BISTABLE 5/2, 1/4"

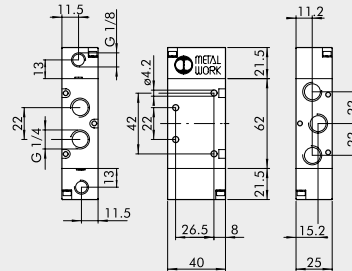

| Symbol | Code | Abbrev. | Weight [g] |
|--------|------------|---------------|------------|
| | 7020011200 | PNV 35 PNB OO | 174 |
| | 7020011300 | PNV 35 PND OO | 198 |

BISTABLE 3/2, 1/4"

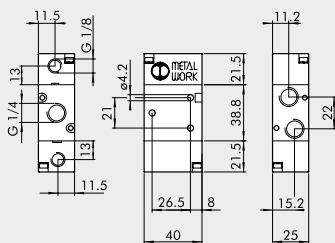

| Symbol | Code | Abbrev. | Weight [g] |
|--------|------------|---------------|------------|
| | 7020010100 | PNV 33 PNB OO | 134 |

DOUBLE 3/2, 1/4"

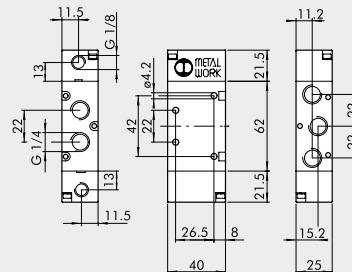

| Symbol | Code | Abbrev. | Weight [g] |
|--------|------------|------------------|------------|
| | 7020013100 | PNV 38 PNS NC | 223 |
| | 7020013200 | PNV 38 PNS NO | 223 |
| | 7020013300 | PNV 38 PNS NC-NO | 223 |

VALVES

VALVES SERIES 70, PNEUMATIC

MONOSTABLE 5/3, 1/4"

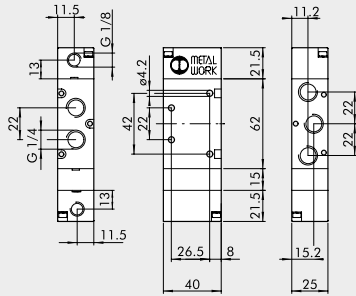

| Symbol | Code | Abbrev. | Weight [g] |
|--------|------------|---------------|------------|
| | 7020012100 | PNV 36 PNS CC | 124 |
| | 7020012200 | PNV 36 PNS OC | 124 |
| | 7020012300 | PNV 36 PNS PC | 124 |

NOTES

VALVES SERIES 70, PNEUMATIC, 3/8"

MONOSTABLE 3/2 NO, 3/8"

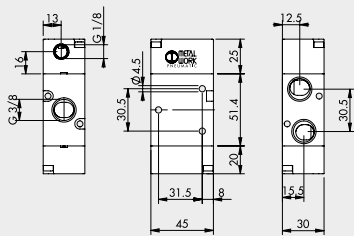

| Symbol | Code | Abbrev. | Weight [g] |
|--------|------------|---------------|------------|
| | 7040010400 | PNV C3 PNS NO | 223 |

MONOSTABLE 3/2 NC, 3/8"

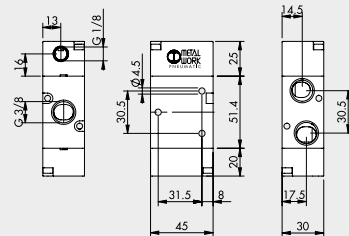

| Symbol | Code | Abbrev. | Weight [g] |
|--------|------------|---------------|------------|
| | 7040010200 | PNV C3 PNS NC | 223 |

MONOSTABLE 5/2, 3/8"

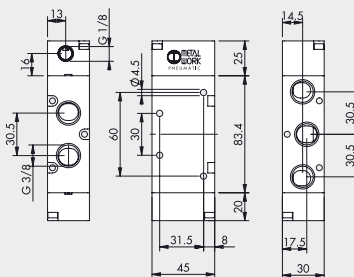

| Symbol | Code | Abbrev. | Weight [g] |
|--------|------------|---------------|------------|
| | 7040011100 | PNV C5 PNS OO | 329 |

BISTABLE 5/2, 3/8"

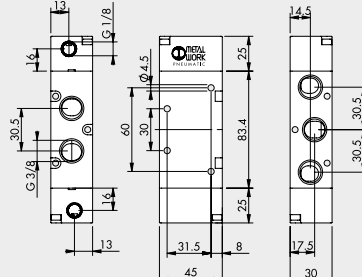

| Symbol | Code | Abbrev. | Weight [g] |
|--------|------------|---------------|------------|
| | 7040011200 | PNV C5 PNB OO | 324 |
| | 7040011300 | PNV C5 PND OO | 360 |

BISTABLE 3/2, 3/8"

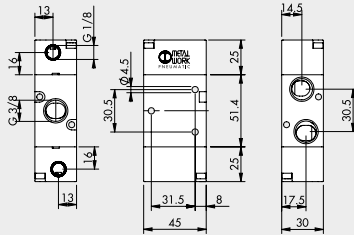

| Symbol | Code | Abbrev. | Weight [g] |
|--------|------------|---------------|------------|
| | 7040010100 | PNV C3 PNB OO | 230 |

MONOSTABLE 5/3, 3/8"

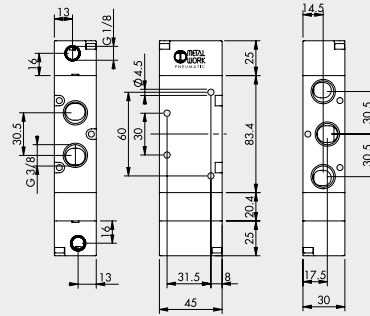

| Symbol | Code | Abbrev. | Weight [g] |
|--------|------------|---------------|------------|
| | 7040012100 | PNV C6 PNS CC | 411 |
| | 7040012200 | PNV C6 PNS OC | 409 |
| | 7040012300 | PNV C6 PNS PC | 409 |

VALVES SERIES 70, PNEUMATIC, 1/2"

MONOSTABLE 3/2 NO, 1/2"

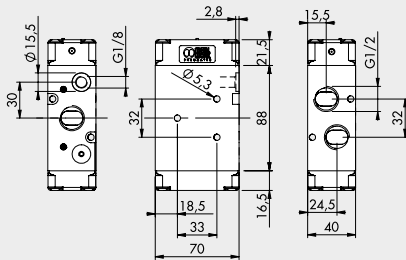

| Symbol | Code | Abbrev. | Weight [g] |
|--------|------------|---------------|------------|
| | 7030010400 | PNV 43 PNS NO | 640 |

MONOSTABLE 3/2 NC, 1/2"

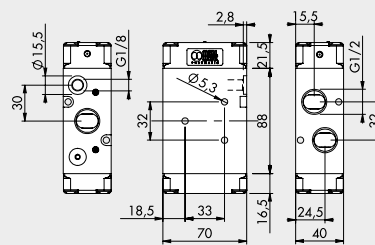

| Symbol | Code | Abbrev. | Weight [g] |
|--------|------------|---------------|------------|
| | 7030010200 | PNV 43 PNS NC | 640 |

MONOSTABLE 5/2, 1/2"

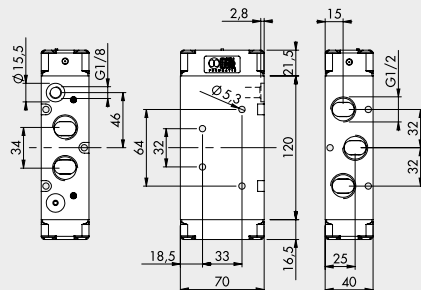

| Symbol | Code | Abbrev. | Weight [g] |
|--------|------------|---------------|------------|
| | 7030011100 | PNV 45 PNS OO | 812 |

BISTABLE 5/2, 1/2"

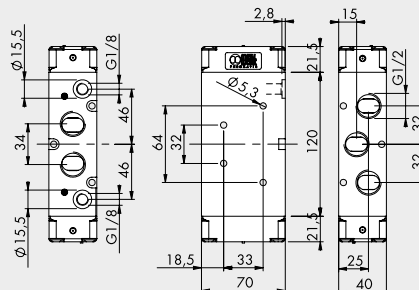

| Symbol | Code | Abbrev. | Weight [g] |
|--------|------------|---------------|------------|
| | 7030011200 | PNV 45 PNB OO | 816 |
| | 7030011300 | PNV 45 PND OO | 828 |

VALVES

VALVES SERIES 70, PNEUMATIC

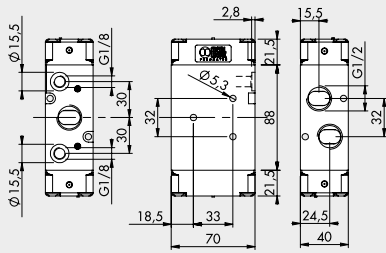

BISTABLE 3/2, 1/2"

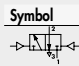

| Symbol | Code | Abbrev. | Weight [g] |
|---|------------|---------------|------------|
|  | 7030010100 | PNV 43 PNB OO | 650 |

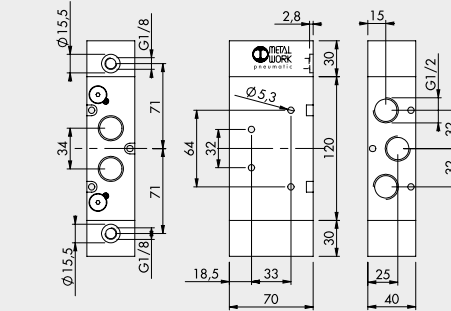
MONOSTABLE 5/3, 1/2"

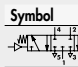

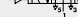
| Symbol | Code | Abbrev. | Weight [g] |
|--|------------|---------------|------------|
|  | 7030012100 | PNV 46 PNS CC | 1200 |
|  | 7030012200 | PNV 46 PNS OC | 1194 |
|  | 7030012300 | PNV 46 PNS PC | 1196 |

NOTES

Accessories

| | Art. No. | Type No. |
|---------------------------------------|-----------------|-----------------|
| Mounting bracket set, height 120.0 mm | 106604 | 518.120-18 |
| Mounting bracket set, height 60.0 mm | 106605 | 518.60-18 |
| Mounting bracket set, height 30.0 mm | 106606 | 518.30-18 |
| Feed block with 2 valve positions | 106610 | 518.02-18 |
| Feed block with 3 valve positions | 106611 | 518.03-18 |
| Feed block with 4 valve positions | 106612 | 518.04-18 |
| Feed block with 5 valve positions | 106613 | 518.05-18 |
| Feed block with 6 valve positions | 106614 | 518.06-18 |
| Feed block with 7 valve positions | 106615 | 518.07-18 |