



Ball valves

- Heavy-duty type
- Full bore
- PN 80*

Type series

- 3340.xx
- 3350.xx
- 3351.xx

G 1/4 ... G 3

G thread acc. to DIN EN ISO 228-1

R 1/4 ... R 2

R thread acc. to DIN EN 10226 (ISO 7-1)

* Note the pressure/temperature diagram

- Extremely robust ball valves for all applications covered by the specifications
- Full Bore
- Aluminium hand / wing lever
- High quality and a long service life guaranteed by extensive tests both during after the production process

Materials

Part	Material
Body	Brass 58, nickel-plated
Ball	Brass 58, hard chrome-plated
Stem	Brass
Stuffing box	Brass
Ball seals	PTFE
Shaft seal	PTFE
Hand lever/butterfly handle	Aluminium

Art. No.	Ident No.	DN	Port				PN [bar]	
			Female G	Female G	Male R	Male R		
3350.02	103261	8	1/4"	1/4"			80	
3350.03	103262	10	3/8"	3/8"				
3350.04	103263	15	1/2"	1/2"				
3350.05	103264	20	3/4"	3/4"				
3350.06	103265	25	1"	1"				
3350.07	103266	32	1 1/4"	1 1/4"				
3350.08	103267	40	1 1/2"	1 1/2"				
3350.09	103268	50	2"	2"		63		
3350.10	103269	65	2 1/2"	2 1/2"		40		
3350.11	103270	80	3"	3"				
3350.22	103271	8	1/4"		1/4"		80	
3350.33	103272	10	3/8"		3/8"			
3350.44	103273	15	1/2"		1/2"			
3350.55	103274	20	3/4"		3/4"			
3350.66	103275	25	1"		1"			
3350.77	103276	32	1 1/4"		1 1/4"			
3350.88	103277	40	1 1/2"		1 1/2"			
3350.99	103278	50	2"		2"	63		
3351.22	103279	8			1/4"	1/4"		100
3351.33	103280	10			3/8"	3/8"		
3351.44	103281	15			1/2"	1/2"		
3351.55	103282	20			3/4"	3/4"		
3351.66	103283	25			1"	1"		
3351.77	103284	32			1 1/4"	1 1/4"		
3351.88	103285	40			1 1/2"	1 1/2"		
3351.99	103286	50			2"	2"	80	

Art. No.	Ident No.	DN	Port				PN [bar]	
			Female G	Female G	Male R	Male R		
3340.02	103287	8	1/4"	1/4"			80	
3340.03	103288	10	3/8"	3/8"				
3340.04	103289	15	1/2"	1/2"				
3340.05	103290	20	3/4"	3/4"				
3340.06	103291	25	1"	1"				
3340.12	103292	8	1/4"		1/4"			100
3340.13	103293	10	3/8"		3/8"			
3340.14	103294	15	1/2"		1/2"			
3340.15	103295	20	3/4"		3/4"			
3340.16	103296	25	1"		1"			
3340.32	103297	8			1/4"	1/4"	100	
3340.33	103298	10			3/8"	3/8"		
3340.34	103299	15			1/2"	1/2"		
3340.35	103300	20			3/4"	3/4"		
3340.36	103301	25			1"	1"		

Pressure / temperature

- Temperature range: -20 °C to + 130 °C
- The pressure resistance is reduced if the temperature rises (see diagram)
- At temperatures below zero the medium may freeze and damage the valve

Applications

- Compressed-air and water
- All non-flammable and non-toxic gases
- Fuels, fuel oil (light distillate), fuel oil (heavy), diesel oils, lubricating oils
- Paints, varnishes and solvents
- Weak alkaline solutions and acids

For thread female/female, female/male

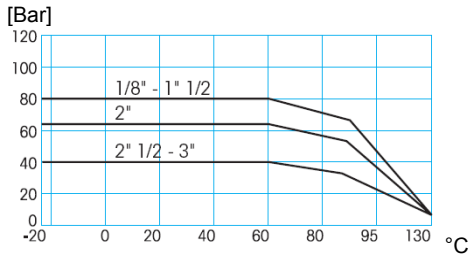

For thread male/male

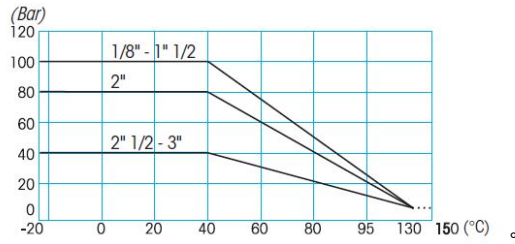

Dimensions [mm]

3350.02 to 3350.11

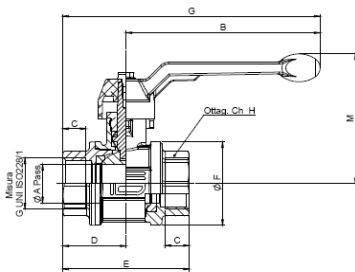

Port	DN	PN	Ø A Pass.	B	C	D	E	Ø F	G	ch. H	L	M
1/4"	8	80	8	75	6,5	20,5	40,5	22,7	95,5	18	6,5	51,5
3/8"	10	80	10	75	8,5	23,0	46,0	28,0	98,0	21	8,5	54,0
1/2"	15	80	15	100	9,5	28,0	55,0	36,0	128,0	26	9,5	64,0
3/4"	20	80	20	120	12,5	32,5	65,0	43,5	132,5	32	12,0	67,5
1"	25	80	25	120	13,5	38,0	76,0	52,5	158,0	39	13,5	80,0
1 1/4"	32	80	32	150	13,5	42,5	85,0	65,0	192,5	49	13,5	94,0
1 1/2"	40	80	40	150	18,0	51,5	103,0	78,0	201,5	56	18,0	103,0
2"	50	63	50	175	20,5	60,5	121,0	95,0	236,0	69	20,5	115,5
2 1/2"	65	40	65	280	24,2	74,0	148,0	119,0	354,0	85	24,2	152,0
3"	80	40	80	280	26,8	86,0	172,0	144,0	366,0	100	26,8	163,5

3350.22 to 3350.99

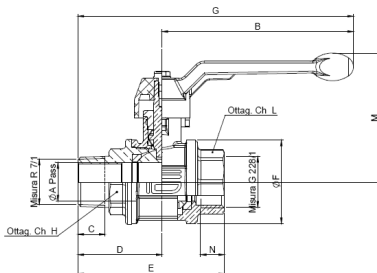

Port	DN	PN	Ø A Pass.	B	C	D	E	Ø F	G	ch. H	ch. L	M	N
1/4"	8	80	8	75	11,0	29,0	49,0	22,7	104	18	18	51,5	7,0
3/8"	10	80	10	75	11,0	33,0	56,0	28,0	108	21	21	54,0	8,5
1/2"	15	80	15	100	14,9	40,7	68,0	36,0	141	27	26	64,0	8,5
3/4"	20	80	20	100	16,0	44,0	77,0	43,5	144	33	32	68,0	14,0
1"	25	80	25	120	19,0	50,3	89,0	53,5	170	40	39	80,0	15,0
1 1/4"	32	80	32	150	21,2	56,7	100,0	65,0	207	50	49	95,0	16,0
1 1/2"	40	80	40	150	21,2	63,0	114,5	78,5	213	57	56	103,0	18,0
2"	50	80	50	175	25,5	76,0	136,0	96,0	251	70	69	115,5	21,0

3351.22 to 3351.99

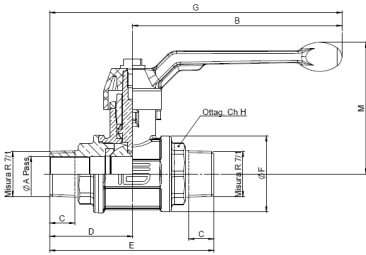

Port	DN	PN	Ø A Pass.	B	C	D	E	Ø F	G	ch. H	M
1/4"	8	100	8	75	10,9	29,0	54,5	22,7	104,0	18	51,5
3/8"	10	100	10	100	11,2	33,0	66,0	28,0	108,0	22	61,0
1/2"	15	100	15	100	14,9	41,0	82,0	36,0	141,0	27	64,0
3/4"	20	100	20	120	16,0	47,5	95,0	43,5	167,5	33	76,0
1"	25	100	25	120	19,0	54,0	107,0	53,5	174,0	40	80,0
1 1/4"	32	100	32	150	21,2	62,0	122,4	65,0	212,0	50	96,4
1 1/2"	40	100	40	150	21,2	68,0	136,0	78,5	218,0	57	102,9
2"	50	80	50	175	25,0	80,5	159,5	96,0	255,5	70	117,8

3340.02 to 3340.06

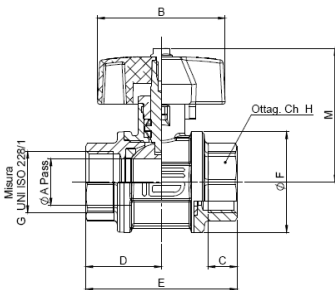

Port	DN	PN	Ø A Pass.	B	C	D	E	Ø F	ch. H	L	M
1/4"	8	80	8	45	6,5	20,5	40,5	22,7	18	6,5	43,0
3/8"	10	80	10	45	8,5	23,0	46,0	28,0	21	8,5	46,0
1/2"	15	80	15	55	9,5	28,0	55,0	36,0	26	9,5	54,5
3/4"	20	80	20	55	12,5	32,5	65,0	43,5	32	12,0	59,0
1"	25	80	25	70	13,5	38,0	76,0	53,5	39	13,5	73,0

3340.12 to 3340.16

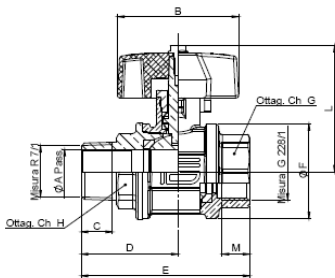

Port	DN	PN	Ø A Pass.	B	C	D	E	Ø F	ch. G	ch. H	L	M
1/4"	8	80	8	45	11,0	29,0	49,0	22,7	18	18	43,0	7,0
3/8"	10	80	10	45	11,0	33,0	56,0	28,0	21	21	45,5	9,0
1/2"	15	80	15	55	15,0	40,7	68,0	36,0	27	26	54,5	8,0
3/4"	20	80	20	55	16,0	44,0	77,0	43,5	33	32	58,5	13,0
1"	25	80	25	70	19,0	50,3	88,4	53,5	40	39	70,5	14,5

3340.32 to 3340.36

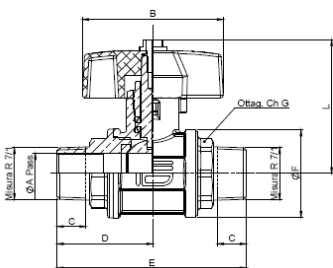

Port	DN	PN	Ø A Pass.	B	C	D	E	Ø F	ch. G	L
1/4"	8	100	8	45	11,0	29,0	54,5	22,7	18	43,0
3/8"	10	100	10	45	11,2	33,0	66,0	28,0	21	51,0
1/2"	15	100	15	55	14,9	41,0	82,0	36,0	27	54,5
3/4"	20	100	20	55	16,1	47,5	94,0	43,5	33	66,0
1"	25	100	25	70	19,0	54,0	107,0	53,5	40	70,0