

L-ring piece

stainless steel

STAINLESS STEEL

Art. No. 110456

Type No. 61.012-12 ES

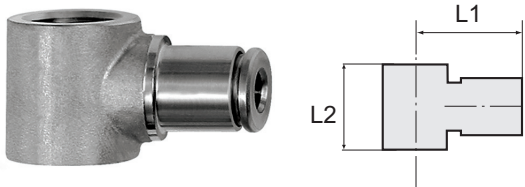

Exemplary illustration

For use with aggressive media and in areas susceptible to corrosive outside influences, in the food processing industry and in hygienic and sanitary applications.

Technical data

| | |
|--------------------------|------------------------|
| Working pressure | max. 15 bar |
| Working pressure pulsate | 10 bar |
| Operating temperature | -20 to 150 °C |
| Medium temperature | -20 to 150 °C |
| Material | Stainless steel 1.4404 |
| Sealant | FKM |
| Standard thread | DIN EN ISO 228-1 |
| Thread | G 1/2 |
| For tube O.D. | 12 mm |
| L1 | 33.0 mm |
| L2 | 24.0 mm |
| Suitable pipe materials | PVDF, PTFE, PA, PU |

The maximum working pressure depends on the pipe quality.

The medium and operating temperature depends on the pipe quality and diameter.

Commercial data

| | |
|-------------------------|--------------|
| Customs tariff number | 73071990 |
| Country of origin | IT |
| eCl@ss 5.1.4 | 27294201 |
| eCl@ss 9.0 | 27294201 |
| UNSPSC_Code_v190501 | 27131613 |
| UNSPSC_CodeDesc_v190501 | Air coupling |

Material informations

| | |
|----------------------------|----------------------------|
| REACH SVHC1 substance name | no |
| CAS no. SVHC 1 | no CAS No. |
| RoHS materials notice | RoHS compliant |
| REACH Info | no SVHC substance included |

Dimensions

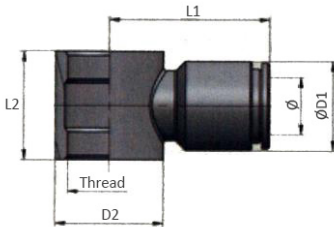

| Thread | Standard thread | For tube O.D. | L1 | L2 | D1 | D2 |
|--------|------------------|---------------|------|------|------|------|
| | | mm | mm | mm | mm | mm |
| G 1/2 | DIN EN ISO 228-1 | 12 | 33.0 | 24.0 | 19.0 | 26.0 |