

# Stopper

Stainless steel 1.4408

**STAINLESS STEEL**

Art. No. 118390

Type No. VSTR112ES4408VK



Exemplary illustration

## Technical data

Max. working pressure	20 bar
Thread	R 1 1/2
L1	28.0 mm
a/f	23 mm
Thread form	tapered male thread
Standard thread	DIN EN ISO 7-1
Version	Square

From thread size of 1 inch, we recommend using an adjustable open-end wrench.

To ensure a proper sealing of the cylindrical threads (G) and tapered threads (R/Rp) we recommend using a suitable sealant (e.g. hemp, sealing tape or suitable industrial adhesive).

## Commercial data

Customs tariff number	73072910
Country of origin	CN
eCl@ss 5.1.4	22360608
eCl@ss 9.0	22560208
UNSPSC_Code_v190501	40173507
UNSPSC_CodeDesc_v190501	Stainless steel pipe plug

## Material informations

REACH SVHC1 substance name	no
CAS no. SVHC 1	no CAS No.
RoHS materials notice	RoHS compliant
REACH Info	no SVHC substance included

## Dimensions

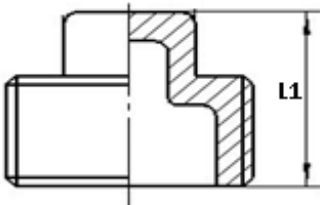

Thread	L1 mm	a/f mm
R 1 1/2	28.0	23

From thread size of 1 inch, we recommend using an adjustable open-end wrench.

To ensure a proper sealing of the cylindrical threads (G) and tapered threads (R/Rp) we recommend using a suitable sealant (e.g. hemp, sealing tape or suitable industrial adhesive).