

# Pressure regulator

for potable water, DVGW-tested acc. to EN 1567



Art. No. 146324

Type No. DRTWR.R112.1-8B



Exemplary illustration

Diaphragm pressure regulator made of red brass with pressure-reduced single-seated valve and built-in strainer. The regulator protects domestic water installations as well as commercial and industrial systems against excessive supply pressure.

## Technical data

Max. input pressure	40 bar
Operating temperature	-20 to 95 °C
Operating temperature max. drinking water	80 °C
Control range	1 - 8 bar
Thread	R 1 1/2 ET
DN	40
a/f	65 mm
Flow rate kvs value	12.5 m <sup>3</sup> /h
Medium	potable water, nitrogen, argon, neutral and non-adhesive liquids, compressed air and neutral gases
Housing	red brass (CC499K)
Internal parts	red brass (CC499K) and stainless steel (1.4404)
Pressure setting	adjusting screw
Pressure spring	spring steel, rust-protected
Screen	stainless steel
Mesh size strainer	0.75 mm
A	130.0 mm
C	70.0 mm
D	165.0 mm

Size R 2 and other control range available on request.

The following approvals are available on request:

- DIN-DVGW type examination (up to 80 °C)
- ACS approval
- WRAS approval (up to 85 °C)
- SINTEF approval
- PZH approval

## Commercial data

Customs tariff number	84811099
Country of origin	DE
eCl@ss 5.1.4	37011108
eCl@ss 9.0	37011108
UNSPSC_Code_v190501	41112404
UNSPSC_CodeDesc_v190501	Pressure regulator

## Flow chart

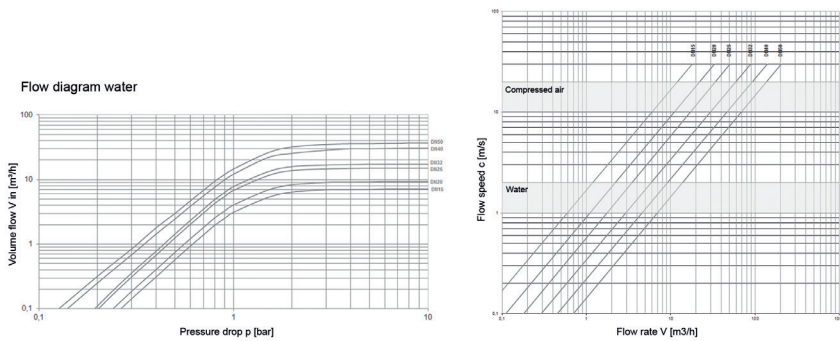

## Dimensions

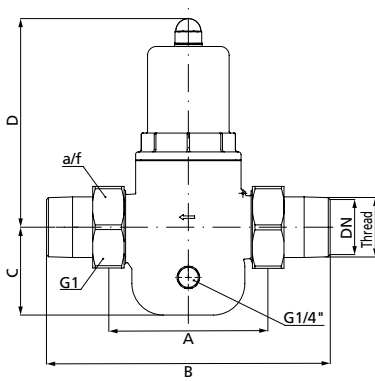

Thread	A	B	C	D	G1	a/f	DN
	mm	mm	mm	mm		mm	
R 1 1/2 ET	130.0	226.0	70.0	165.0	G 2 ET	65	40

## Application examples

Use of pressure reducers if a certain pressure must not be exceeded on the outlet side of the pipe network despite different pressures on the inlet side

- potable water supply in accordance with DIN 1988
- service water supply in industrial and building technology
- snowmaking systems
- fire extinguishing technology and sprinkler systems
- shipbuilding and offshore systems

## Spareparts

	<b>Art. No.</b>	<b>Type No.</b>
Valve insert for R 1 1/2	146314	VEDRTWR.R112
Pressure gauge Ø 63 mm, G 1/4 ET, 0 - 10 bar/145 psi	101244	217-KD