

Stopper valve, straight push-in fitting

»blue series«

EASY

Art. No. 151442

Type No. 195.146-2

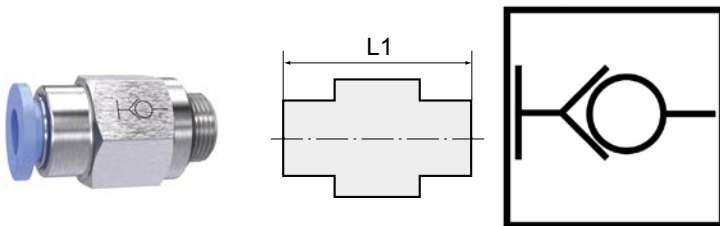

Exemplary illustration

Functional principle of a coupling: The compressed air supply is completely shut off as soon as the hose is detached from the connector.

Flow is only guaranteed when the hose is firmly inserted.

Attention: Only release the hose without pressure and hold the end of the hose to the plug connection when loosening to prevent injuries from the "whip effect".

Technical data

| | |
|-------------------|---------------------------------|
| Working pressure | 0 - 10 bar |
| Temperature range | 0 to 60 °C |
| Series | Blue series |
| Material | Plastic and nickel-plated brass |
| Medium | Compressed air |
| Sealant | NBR |
| Sleeve | Plastic blue |
| Applications | Compressed air systems |
| Recommended hose | PU or PA (nylon) |
| Function | Self-locking |
| Thread form | Parallel male thread |
| Standard thread | DIN EN ISO 228-1 |
| Version | With o-ring (NBR) |
| Thread | G 1/4 |
| For tube O.D. | 6 mm |
| L1 | 27.5 mm |
| a/f | 14 mm |

The suitability test for the use with alternative specifications is the user's responsibility.

Commercial data

| | |
|-------------------------|--------------|
| Customs tariff number | 39174000 |
| Country of origin | CN |
| eCl@ss 5.1.4 | 27294201 |
| eCl@ss 9.0 | 27294201 |
| UNSPSC_Code_v190501 | 27131613 |
| UNSPSC_CodeDesc_v190501 | Air coupling |

Dimensions

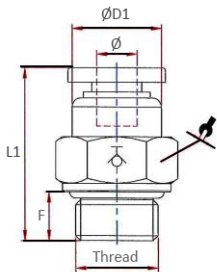

| Thread | Standard thread | For tube O.D. mm | F mm | a/f mm | L1 mm | D1 mm |
|--------|------------------|---------------------|---------|-----------|----------|----------|
| G 1/4 | DIN EN ISO 228-1 | 6 | 6.5 | 14 | 27.5 | 12.0 |

Accessories

| | Art. No. | Type No. |
|---|----------|----------|
| Loosening tool, quick-connect fittings, hose exterior Ø 3 - 10 mm | 108853 | LW3-10 |
| Loosening tool, quick-connect fittings, hose exterior Ø 4-14 mm | 121863 | LW4-14 |