

# Stopper valve, straight push-in fitting

»blue series«

**EASY**

Art. No. 151445

Type No. 195.388-2

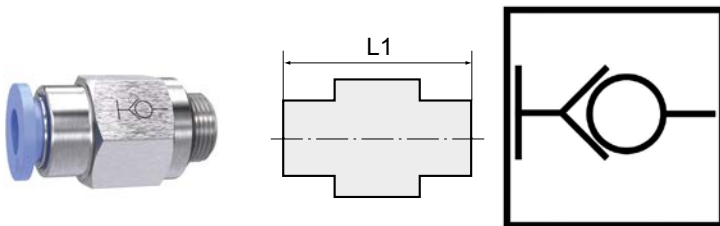

Exemplary illustration

Functional principle of a coupling: The compressed air supply is completely shut off as soon as the hose is detached from the connector.

Flow is only guaranteed when the hose is firmly inserted.

Attention: Only release the hose without pressure and hold the end of the hose to the plug connection when loosening to prevent injuries from the "whip effect".

## Technical data

|                   |                                 |
|-------------------|---------------------------------|
| Working pressure  | 0 - 10 bar                      |
| Temperature range | 0 to 60 °C                      |
| Series            | Blue series                     |
| Material          | Plastic and nickel-plated brass |
| Medium            | Compressed air                  |
| Sealant           | NBR                             |
| Sleeve            | Plastic blue                    |
| Applications      | Compressed air systems          |
| Recommended hose  | PU or PA (nylon)                |
| Function          | Self-locking                    |
| Thread form       | Parallel male thread            |
| Standard thread   | DIN EN ISO 228-1                |
| Version           | With o-ring (NBR)               |
| Thread            | G 3/8                           |
| For tube O.D.     | 8 mm                            |
| L1                | 33.5 mm                         |
| a/f               | 17 mm                           |

The suitability test for the use with alternative specifications is the user's responsibility.

## Commercial data

|                         |              |
|-------------------------|--------------|
| Customs tariff number   | 39174000     |
| Country of origin       | CN           |
| eCl@ss 5.1.4            | 27294201     |
| eCl@ss 9.0              | 27294201     |
| UNSPSC_Code_v190501     | 27131613     |
| UNSPSC_CodeDesc_v190501 | Air coupling |

## Dimensions

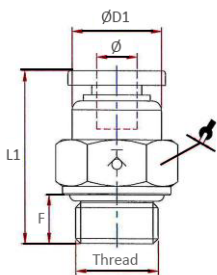

| Thread | Standard thread  | For tube O.D. | F   | a/f | L1   | D1   |
|--------|------------------|---------------|-----|-----|------|------|
|        |                  | mm            | mm  | mm  | mm   | mm   |
| G 3/8  | DIN EN ISO 228-1 | 8             | 7.0 | 17  | 33.5 | 14.0 |

## Accessories

|   | Art. No. | Type No. |
|---|----------|----------|
| Loosening tool, quick-connect fittings, hose exterior Ø 3 - 10 mm | 108853   | LW3-10   |
| Loosening tool, quick-connect fittings, hose exterior Ø 4-14 mm   | 121863   | LW4-14   |